

Job Name:		Location:	
Purchaser:		Submitted By:	
Submitted To:		Engineer:	
Date:		Application:	

Reference    Approval    Construction



### Basic product info.

IDU Model Number	PVA-AA30NL
IDU Model Code	32P103
ODU Model Number	PUZ-AK30NLHZ
AHRI Certificate	215712209

### Performance: Cooling at 95F (35C)

Cooling 95F Maximum Capacity	31000	Btu/h
Cooling 95F Rated Capacity	30000	Btu/h
Cooling 95F Minimum Capacity	12600	Btu/h
Cooling Maximum Power Input	2300	W
Cooling Rated Power Input	2210	W
Cooling Minimum Power Input	680	W
Moisture removal at AHRI Cooling Rating Conditions	6.6	Pints/h
Sensible Heat Factor at AHRI Cooling Rating Conditions	0.76	-

### Performance: Heating at 47F (8.3C)

Heating 47F Maximum Capacity	34000	Btu/h
Heating 47F Rated Capacity	32000	Btu/h
Heating 47F Minimum Capacity	11500	Btu/h
Heating 47F Maximum Power Input	2350	W
Heating 47F Rated Power Input	2190	W
Heating 47F Minimum Power Input	620	W
COP 47F at Rated Condition	4.2	

### Performance: Heating at 17F (-8.3C)

Heating 17F Maximum Capacity	32000	Btu/h
Heating 17F Rated Capacity	21600	Btu/h
Heating 17F Minimum Capacity	8300	Btu/h
Heating 17F Maximum Power Input	4650	W
Heating 17F Rated Power Input	2250	W
Heating 17F Minimum Power Input	1120	W
COP 17F at Maximum capacity	2	
COP 17F at Rated Condition	2.8	

### Performance: Heating at 5F (-15C)

Heating 5F Maximum Capacity (H4Full)	32000	Btu/h
Heating 5F Rated Capacity (H4Full)	18700	Btu/h
Heating 5F Minimum Capacity (H4Full)	7000	Btu/h
Heating 5F Maximum Power Input (H4Full)	3960	W
Heating 5F Rated Power Input (H4Full)	2180	W
Heating 5F Minimum Power Input (H4Full)	1230	W
COP 5F at Maximum capacity (H4Full)	2.3	

### Performance: Heating at -13F (-25C)

COP -13F at Maximum Capacity	1.84	
Heating -13F Maximum Capacity	21000	Btu/h
Heating -13F Minimum Capacity	4600	Btu/h
Heating -13F Maximum Power Input	3330	W
Heating -13F Minimum Power Input	1130	W

### ODU Operating Temp. Range

Heating Thermal Re-start Temp	-13 / -25	F° / C°
Heating Thermal Lock-out Temp	-22 / -30	F° / C°
Heating Thermal Re-start Temp (F)	-13 / -25	F° / C°
Heating Thermal Lock-out Temp (F)	-22 / -30	F° / C°

**Rebates**

Energy Star 6.1 Certified	Yes	
Energy Star 6.1 Cold Climate Certified	Yes	
NEEP Certification	Yes	

**Efficiency**

SEER2	21	
EER2	13.5	
HSPF2 (IV)	9.3	
HSPF2 (V)	7.8	

**Electrical**

Rated Voltage (Min)	208	V AC
Rated Voltage (Max)	230	V AC
Phase	1	
Short-circuit Current Rating (SCCR)	5	kA
Recommended Fuse/Breaker Size	30	A
ODU Minimum Circuit Ampacity (MCA)	29	A
ODU Maximum Over Current Protection (MOCP) = MOP = Maximum Fuse	48	A

**Indoor Unit**

IDU Airflow Rate at Heating 1	613	CFM
IDU Airflow Rate at Heating 2	744	CFM
IDU Airflow Rate at Heating 3	875	CFM
IDU Unit Dimension W	21.0625	inch
IDU Unit Dimension D	21.625	inch
IDU Unit Dimension H	54.3125	inch
IDU Unit Weight	141	lbs
IDU Airflow Rate at Cooling, Dry 1	613	CFM
IDU Airflow Rate at Cooling, Dry 2	744	CFM
IDU Airflow Rate at Cooling, Dry 3	875	CFM

**Outdoor Unit**

ODU Fan Motor Output	0.0992 + 0.0992	HP
Base Pan Heater installed (Built-in or Optional)	Built-in	
ODU Unit Dimension W	41.375	inch
ODU Unit Dimension D	14	inch
ODU Unit Dimension H	52.6875	inch
ODU Unit Weight	231.4851	lbs

**Piping**

Gas Pipe Size O.D. [Flared]	5/8	inch
Liquid Pipe Size O.D. [Flared]	3/8	inch
Maximum Height Difference	98.4252	ft
Maximum Piping Length	246.063	ft

**Refrigerant**

Refrigerant Type	R454B	
Pre-charged Refrigerant Amount	158.733	oz
Maximum Pre-charged Piping Length	98.4252	ft

**Accessories**

Wall Mount controller	PAR-42MAACAB	
Simple Wall MA Controller	PAC-YT53CRAU-J	
Simple CN105 Controller	PAC-SDW01	
NA T-STAT Interface	RMF-CA100	
Wi-Fi Adapter	PAC-USWHS002	

AHRI Rated Conditions (Rated data is determined at a fixed compressor speed) (\* Windscreens required for cooling operations below 23°F (-5°C))

- <sup>1</sup> Cooling (Indoor // Outdoor) 80°F (26.6°C) DB, 67°F (19.4°C) WB // 95°F (35°C) DB, 75°F (23.9°C) WB
- <sup>2</sup> Heating at 47°F (8.3°C) (Indoor // Outdoor) 70°F (21.1°C) DB, 60°F (15.6°C) WB // 47°F (8.3°C) DB, 43°F (6.1°C) WB
- <sup>3</sup> Heating at 17°F (-8.3°C) (Indoor // Outdoor) 70°F (21.1°C) DB, 60°F (15.6°C) WB // 17°F (-8.3°C) DB, 15°F (-9.4°C) WB
- tHeating at 5°F (-15°C) (Indoor // Outdoor) 70°F (21.1°C) DB, 60°F (15.6°C) WB // 5°F (-15°C) DB, 4°F (-15.6°C) WB
- uHeating at -4°F (-20°C) (Indoor // Outdoor) 70°F (21.1°C) DB, 60°F (15.6°C) WB // -4°F (-20°C) DB, -15°F (-26.1°C) WB

PVA-AA30NL

Units: mm (in.)

Model code	A	B	C	D	E	F	G	H	J	Gas Pipe	Liquid Pipe
12	437 (17.1)	316 (12.43/16)	281 (11.06)	224 (8.81/8)	1275 (50.1/4)	686 (26.99/16)	823 (32.77/16)	735.5 (28.9)	360 (14.3/16)	ø 21.7 (1/2)	ø 15.3 (1/4)
18	514 (20.1)	471 (18.53/16)	382.6 (15.04/16)	286.5 (11.27/8)	1316 (51.81/4)	731 (28.77/16)	933.5 (37.11/16)	792 (31.19/16)	461 (18.5/16)		
30	635 (25.0)	579 (22.81/16)	484.6 (19.07/8)	311.5 (12.27/8)	1511 (59.49/4)	798.5 (31.43/16)	1053 (41.42/16)	853.5 (33.59/16)	583 (22.93/16)		
42											

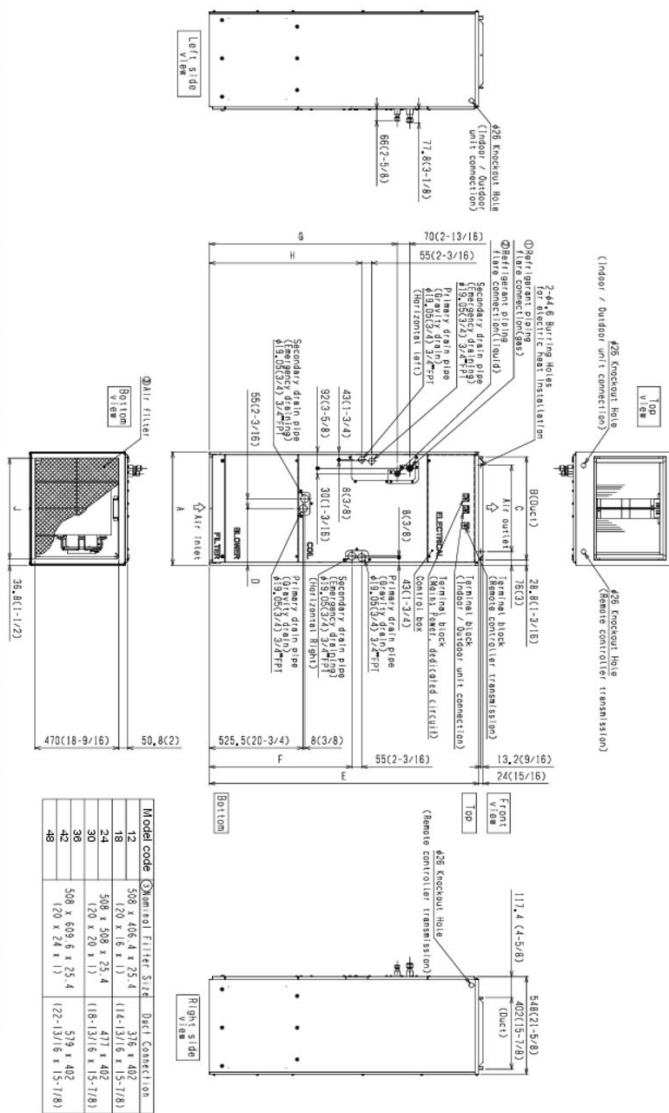

Provide enough clearance in front of unit for service and maintenance. Electrical entrance for PVA located on both left and right side of the cabinet. See the right or left side view for knockout locations.

PUZ-AK30NLHZ-U1

Unit: mm<in>

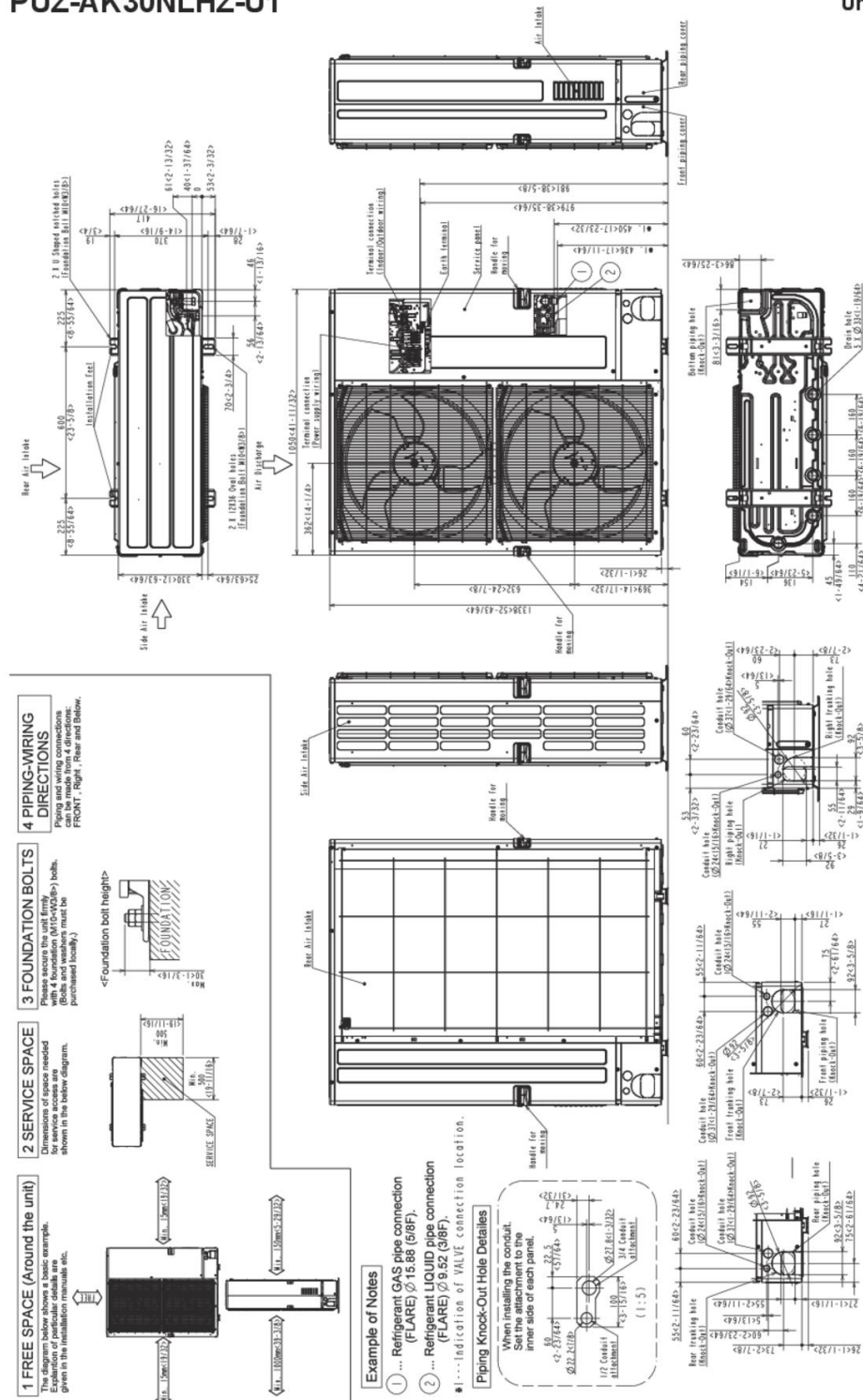

**4 PIPING-WIRING DIRECTIONS**  
Piping and wiring connections FRONT, RIGHT, REAR AND BELOW.

**3 FOUNDATION BOLTS**  
Please secure the unit firmly. Foundation bolts and washers must be purchased locally.

**2 SERVICE SPACE**  
Dimensions of space needed for service are shown in the below diagram.

**1 FREE SPACE (Around the unit)**  
The diagram below shows a basic example. Dimensions of service space are shown in the installation manual, etc.

**Example of Notes**

- ① ... Refrigerant GAS pipe connection (FLARE)  $\varnothing$ 16.88 (5/8F).
- ② ... Refrigerant LIQUID pipe connection (FLARE)  $\varnothing$ 9.52 (3/8F).
- \* ... Indication of VALVE connection location.

