

Job Name:		Location:	
Purchaser:		Submitted By:	
Submitted To:		Engineer:	
Date:		Application:	

Reference Approval Construction



Basic product info.

IDU Model Number	PVA-AA42NL
IDU Model Code	32P105
ODU Model Number	PUZ-AK42NLHZ
AHRI Certificate	215712221

Performance: Cooling at 95F (35C)

Cooling 95F Maximum Capacity	43000	Btu/h
Cooling 95F Rated Capacity	42000	Btu/h
Cooling 95F Minimum Capacity	17900	Btu/h
Cooling Maximum Power Input	3780	W
Cooling Rated Power Input	3660	W
Cooling Minimum Power Input	1060	W
Moisture removal at AHRI Cooling Rating Conditions	6.6	Pints/h
Sensible Heat Factor at AHRI Cooling Rating Conditions	0.83	-

Performance: Heating at 47F (8.3C)

Heating 47F Maximum Capacity	54000	Btu/h
Heating 47F Rated Capacity	48000	Btu/h
Heating 47F Minimum Capacity	16100	Btu/h
Heating 47F Maximum Power Input	4310	W
Heating 47F Rated Power Input	3760	W
Heating 47F Minimum Power Input	930	W
COP 47F at Rated Condition	3.7	

Performance: Heating at 17F (-8.3C)

Heating 17F Maximum Capacity	48000	Btu/h
Heating 17F Rated Capacity	32200	Btu/h
Heating 17F Minimum Capacity	13000	Btu/h
Heating 17F Maximum Power Input	7160	W
Heating 17F Rated Power Input	3600	W
Heating 17F Minimum Power Input	2110	W
COP 17F at Maximum capacity	1.9	
COP 17F at Rated Condition	2.6	

Performance: Heating at 5F (-15C)

Heating 5F Maximum Capacity (H4Full)	48000	Btu/h
Heating 5F Rated Capacity (H4Full)	29300	Btu/h
Heating 5F Minimum Capacity (H4Full)	8700	Btu/h
Heating 5F Maximum Power Input (H4Full)	7560	W
Heating 5F Rated Power Input (H4Full)	3460	W
Heating 5F Minimum Power Input (H4Full)	1740	W
COP 5F at Maximum capacity (H4Full)	1.8	

Performance: Heating at -13F (-25C)

COP -13F at Maximum Capacity	1.86	
Heating -13F Maximum Capacity	36700	Btu/h
Heating -13F Minimum Capacity	5800	Btu/h
Heating -13F Maximum Power Input	5730	W
Heating -13F Minimum Power Input	1640	W

ODU Operating Temp. Range

Heating Thermal Re-start Temp	-13 / -25	F° / C°
Heating Thermal Lock-out Temp	-22 / -30	F° / C°
Heating Thermal Re-start Temp (F)	-13 / -25	F° / C°
Heating Thermal Lock-out Temp (F)	-22 / -30	F° / C°

Rebates

Energy Star 6.1 Certified	No	
Energy Star 6.1 Cold Climate Certified	Yes	
NEEP Certification	Yes	

Efficiency

SEER2	18.7	
EER2	11.4	
HSPF2 (IV)	8.7	
HSPF2 (V)	7.3	

Electrical

Rated Voltage (Min)	208	V AC
Rated Voltage (Max)	230	V AC
Phase	1	
Short-circuit Current Rating (SCCR)	5	kA
Recommended Fuse/Breaker Size	40	A
ODU Minimum Circuit Ampacity (MCA)	35	A
ODU Maximum Over Current Protection (MOCP) = MOP = Maximum Fuse	60	A

Indoor Unit

IDU Airflow Rate at Heating 1	1040	CFM
IDU Airflow Rate at Heating 2	1262	CFM
IDU Airflow Rate at Heating 3	1485	CFM
IDU Unit Dimension W	25	inch
IDU Unit Dimension D	21.625	inch
IDU Unit Dimension H	59.5	inch
IDU Unit Weight	172	lbs
IDU Airflow Rate at Cooling, Dry 1	1040	CFM
IDU Airflow Rate at Cooling, Dry 2	1262	CFM
IDU Airflow Rate at Cooling, Dry 3	1485	CFM

Outdoor Unit

ODU Fan Motor Output	0.2682 + 0.2682	HP
Base Pan Heater installed (Built-in or Optional)	Built-in	
ODU Unit Dimension W	41.375	inch
ODU Unit Dimension D	14	inch
ODU Unit Dimension H	52.6875	inch
ODU Unit Weight	271.16826	lbs

Piping

Gas Pipe Size O.D. [Flared]	5/8	inch
Liquid Pipe Size O.D. [Flared]	3/8	inch
Maximum Height Difference	98.4252	ft
Maximum Piping Length	246.063	ft

Refrigerant

Refrigerant Type	R454B	
Pre-charged Refrigerant Amount	183.4248	oz
Maximum Pre-charged Piping Length	98.4252	ft

Accessories

Wall Mount controller	PAR-42MAACAB
Simple Wall MA Controller	PAC-YT53CRAU-J
Simple CN105 Controller	PAC-SDW01
NA T-STAT Interface	RMF-CA100
Wi-Fi Adapter	PAC-USWHS002

AHRI Rated Conditions (Rated data is determined at a fixed compressor speed) (* Windscreens required for cooling operations below 23°F (-5°C))

- ¹ Cooling (Indoor // Outdoor) 80°F (26.6°C) DB, 67°F (19.4°C) WB // 95°F (35°C) DB, 75°F (23.9°C) WB
- ² Heating at 47°F (8.3°C) (Indoor // Outdoor) 70°F (21.1°C) DB, 60°F (15.6°C) WB // 47°F (8.3°C) DB, 43°F (6.1°C) WB
- ³ Heating at 17°F (-8.3°C) (Indoor // Outdoor) 70°F (21.1°C) DB, 60°F (15.6°C) WB // 17°F (-8.3°C) DB, 15°F (-9.4°C) WB
- tHeating at 5°F (-15°C) (Indoor // Outdoor) 70°F (21.1°C) DB, 60°F (15.6°C) WB // 5°F (-15°C) DB, 4°F (-15.6°C) WB
- uHeating at -4°F (-20°C) (Indoor // Outdoor) 70°F (21.1°C) DB, 60°F (15.6°C) WB // -4°F (-20°C) DB, -15°F (-26.1°C) WB

PVA-AA42NL

Units: mm (in.)

Model code	A	B	C	D	E	F	G	H	J	Gas Pipe	Liquid Pipe
12	432 (17.1)	316 (12.43/16)	281 (11.1/8)	224 (8.83/8)	1275 (50.1/4)	686 (26.99/16)	823 (32.7/16)	735.5 (29)	360 (14.3/16)	Ø 27.7 (1.12)	Ø 35 (1.4)
18	514 (20.1)	471 (18.53/16)	382.6 (15.1/8)	286.5 (11.0/12)	1316 (52.1/4)	793 (29.1/16)	953.5 (37.9/16)	792 (31.3/16)	461 (18.5/16)		
30	635 (25)	579 (22.81/16)	484.6 (19.1/8)	311.5 (12.2/12)	1511 (59.1/2)	798.5 (31.7/16)	1053 (41.1/2)	853.5 (33.5/8)	583 (22.9/16)		
42											

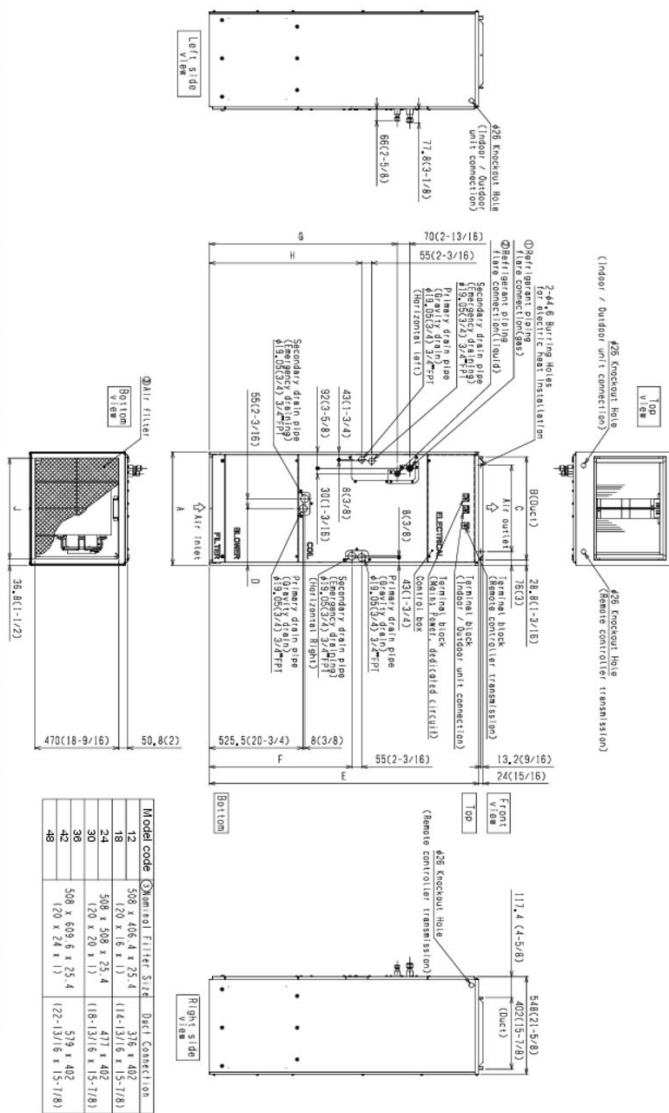

Provide enough clearance in front of unit for service and maintenance. Electrical entrance for PVA located on both left and right side of the cabinet. See the right or left side view for knockout locations.

PUZ-AK42NLHZ-U1

Unit: mm<in>

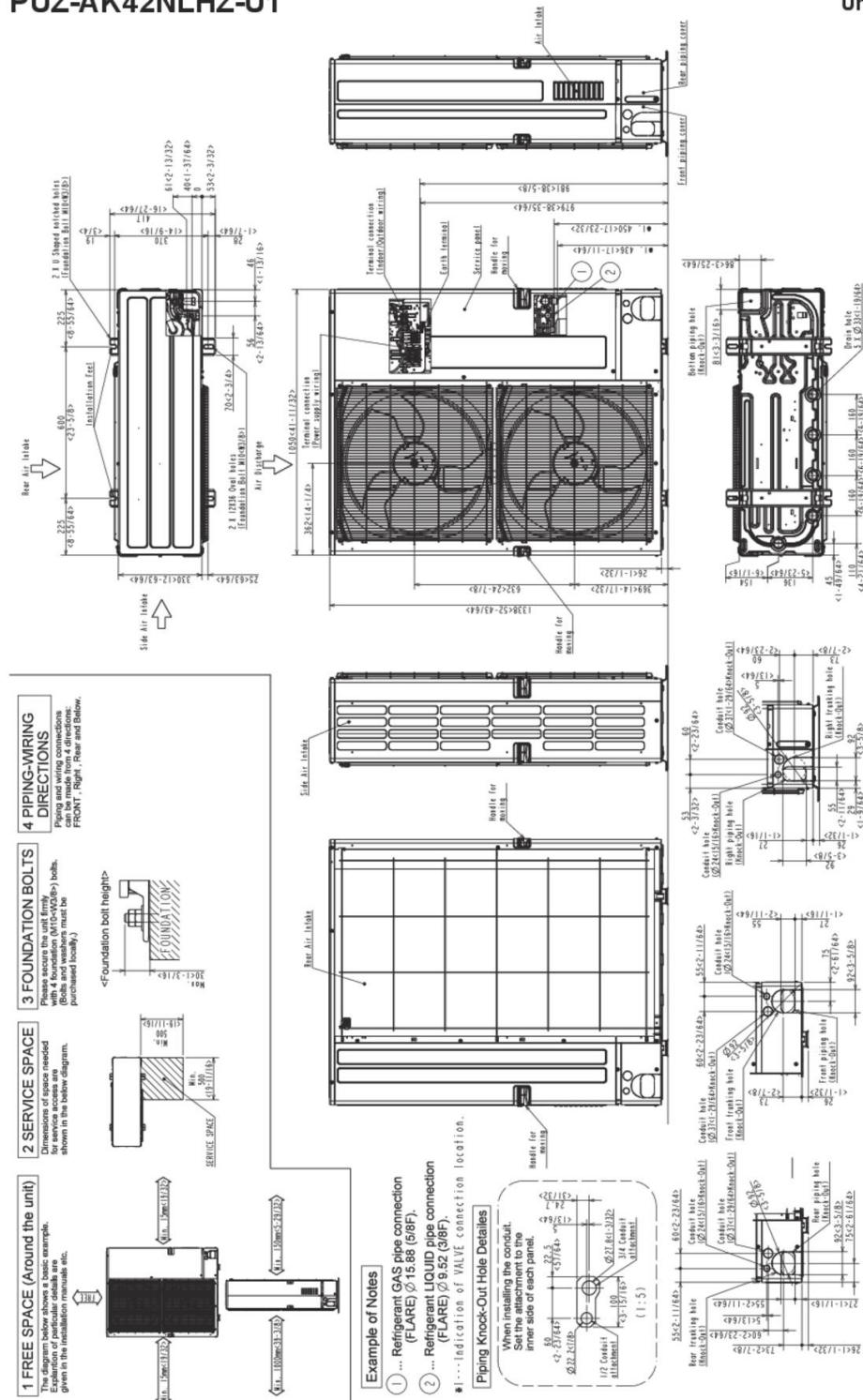

- 1 FREE SPACE (Around the unit)**
The diagram below shows a basic example. Dimensions and clearances are shown in the below diagram.
- 2 SERVICE SPACE**
Dimensions of space needed for service are shown in the below diagram.
- 3 FOUNDATION BOLTS**
Please secure the unit firmly. Bolts and washers must be purchased locally.
- 4 PIPING-WIRING DIRECTIONS**
Piping and wiring connections FRONT, RIGHT, REAR AND BELOW.

Example of Notes

- ① ... Refrigerant GAS pipe connection (FLARE) \varnothing 15.88 (5/8F).
- ② ... Refrigerant LIQUID pipe connection (FLARE) \varnothing 9.52 (3/8F).

* ... Indication of VALVE connection location.

